

LAVO 乐沃

智能家居領導品牌

使用 說明書

USER MANUAL



L133-ZB

智能指紋密碼鎖

INTELLIGENT FINGERPRINT
COMBINATION LOCK

樂享生活 由您掌沃



初次使用

本指紋鎖出廠時均為初始狀態，第一次使用時請先設置“用戶密碼”才能激活密碼面板，具體設置方法請參閱第7頁“密碼設置”。

初始管理員密碼默認為1234，請及時修改。

初次使用時，網關和本鎖會自動連接，如連接不上請參閱第15頁“網絡設置”。

使用須知

在使用本產品之前，請務必先仔細閱讀本使用說明書

請務必妥善保管好本書，以便日後能隨時查閱

請在充分理解內容的基礎上，正確使用

可從樂沃網站下載本使用說明書：www.lavo.cn

網站首頁——服務支持——下載中心

統一服務熱線：400-165-8588



宏洋金属（昆山）有限公司

隸屬於LCM集團，成立於1968年。集團現時擁有臺灣及大陸共兩個生產工廠及遍佈各地的門市及經銷點，員工人數已達二千多人。產品銷往全世界八十多個國家和地區，服務與銷售網路更遍佈全球。

公司具有從產品研發、設計、模具開發製造、壓鑄、加工、研磨、電鍍、烤漆到組合包裝的一貫化流程工作，擁有各類專業的生產設備和質檢設備，主要包括：CNC加工中心、壓鑄機、低壓鑄造機、重力鑄造機、鍛造機、自動衝床、數控線切割機、數控電火花機、高速銑床、CNC數控及普通車床、磨床、鑽床、自動加工機、自動拋光、中國第一套環保無氰電鍍自動流水線、精密資料頻譜分析儀、數位晶相分析儀與多種專業質量檢測儀器設備等。是目前國內規模最大的指紋鎖生產製造廠商，也是為歐美與韓國等全球知名品牌合作提供OEM/ODM代加工產品的生產製造廠商。

目录

1. 正確輸入指紋方法
2. 產品特征
3. 產品規格
4. 各部件名稱
5. 門鎖按鍵說明
6. 密碼設置
7. 指紋設置
8. 指紋刪除
9. 語言設置
10. 音量設置
11. 雙重保安設置
12. 常開功能設置
13. 網絡設置
14. 初始化設置
15. 使用注意事項
16. 售後服務
17. 服務基準

1. 正確輸入指紋方法

手指放置示意

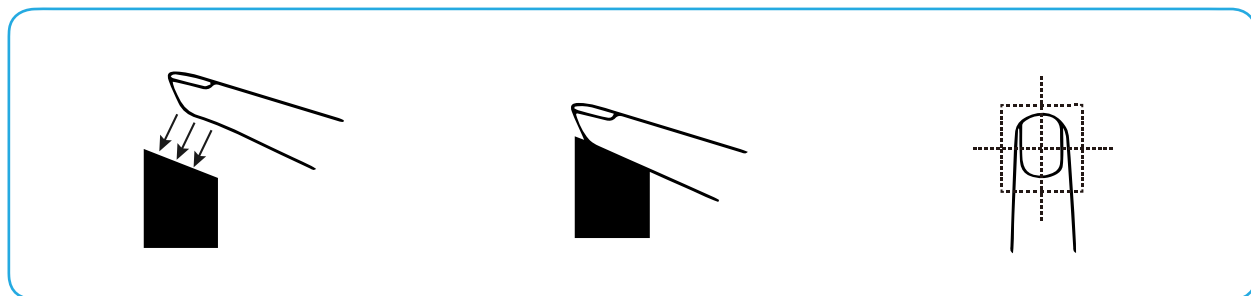

電容式360° 半導體指紋識別

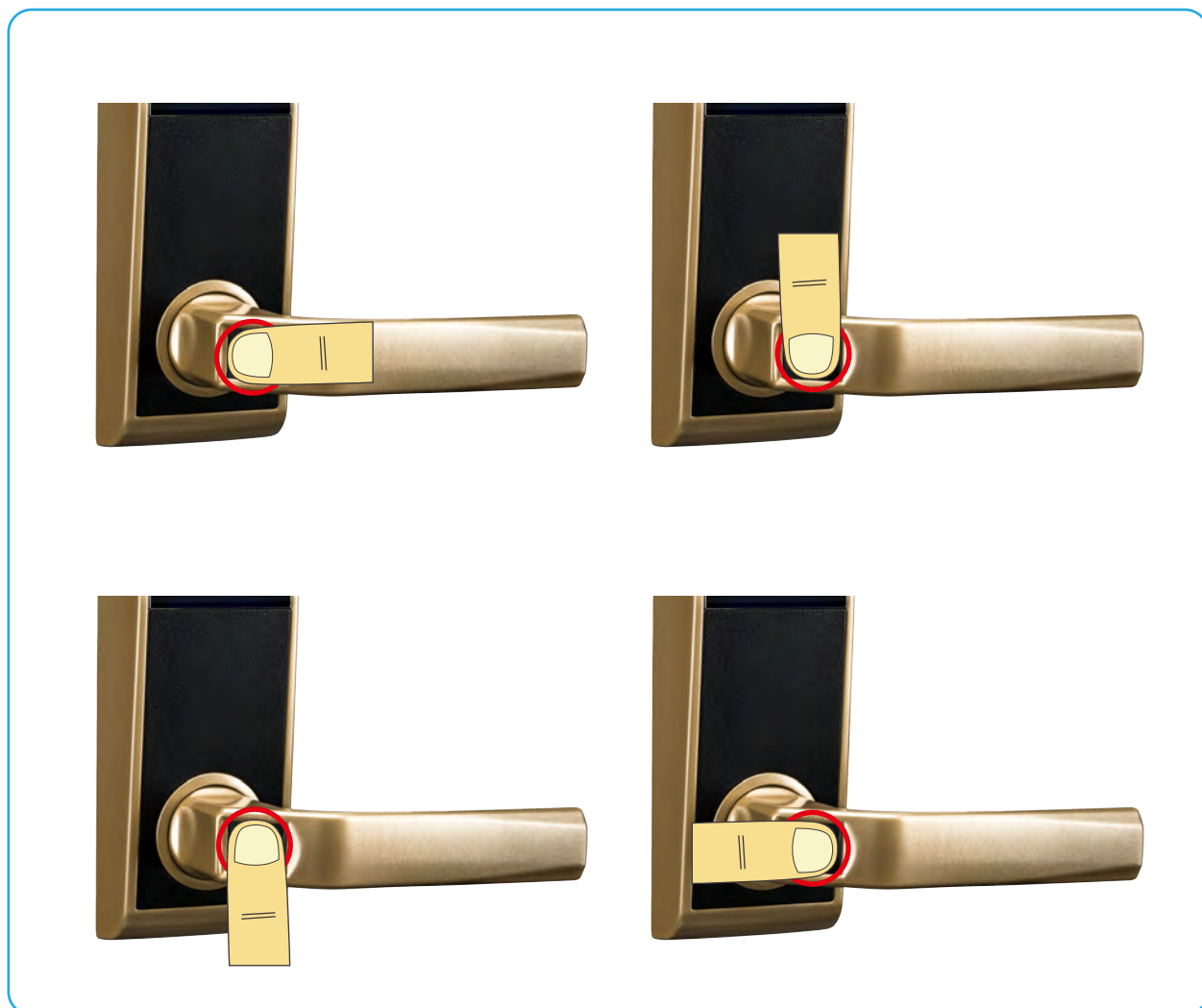

2. 產品特征

指紋生物識別技術

值得信賴的全球最新指紋算法，具有指紋智能記憶功能，可記錄習慣性指紋輸入動作，徹底解決了人造假指紋問題，安全有保障。

電容式360° 半導體指紋識別

觸摸把手指紋視窗自動上電，指紋識別速度反應靈敏。

觸摸屏密碼按鍵

鋼化玻璃觸摸屏，LED密碼按鍵，堅固耐用，操作方便，反應敏捷。

密碼亂碼輸入功能（防止旁人偷窺密碼）

輸入正確密碼前後，可輸入任意總數不超過12位的亂碼，防止密碼泄露。

采用觸摸密碼鍵盤

當觸摸數字鍵時，該數字鍵背景燈變為紅色，觸摸下一個數字時上一個數字背景燈變為白色，該數字背景燈變為紅色。

語音提示功能

真人語音提示功能：中英文語音可選。

上電功能

手指觸摸密碼區就可直接上電，無需按上電鍵進行上電。

電擊保護（ESD保護）

受到高壓電擊後仍能正常工作。

天地鎖功能

根據國內防盜門設計的電控鎖體，出門時只需將把手上提，天地鎖即可上鎖，增加安全性。

戶內反鎖功能

防止兒童誤觸反鎖扭設計，反鎖時需將反鎖扭放外拉才能旋轉，解除反鎖時可直接旋轉。

應急機械鑰匙緊急開啟

當遇到電池沒電或其它問題時，您可以使用應急機械鑰匙緊急開啟。

雙重保安

開門時，同時輸入正確的密碼和指紋，門才能開啟，增強安全性。

緊急電流系統（DC9V）

當電池沒電無法開門時，您可以接外部電源正常使用。

低電量提醒功能

當電池低電壓開門時，輸入密碼或指紋輸入時，語音會提示“電池電量不足，請及時更換電池”。

3.產品規格

| 名稱 | 規格 | 備註 |
|---------|---------------------------|--|
| 室外（前鎖體） | 70 (W) X 300 (H) X 40 (D) | 電壓：DC6V 溫度：-20°C--+70°C 濕度：10%-95%RH |
| 室內（後鎖體） | 70 (W) X 300 (H) X 35 (D) | |
| 把手 | 鋅合金鑄件（前、後把手） | 符合人體工學設計 |
| 其它 | 應急鑰匙3把 | 可輸入4-12位密碼 最多輸入100枚指紋 |
| 重量 | 4.5KG | |
| 觸摸密碼按鍵 | 12个 | 鋼化玻璃觸摸屏 |
| 電源 | 4節1.5VAA型碱性干電池 | 電池壽命6-12個月 (根據電池性能，使用次數會有所差別) |
| 鎖芯 | 雙排原子超B級銅鎖芯 | 產品材質：銅、鍍鉻 |

電池壽命是本公司測試結果，實際情況根據安裝地方的溫度、濕度、使用的次數和電池的品質會有所差別。

放入幹電池時請確認“+”“-”極，放入錯誤會導致幹電池漏液或破損；請勿混用新、舊或已用完的電池；使用不良幹電池會導致產品發生異常，請使用正品碱性幹電池。

4.各部件名稱

前面板

觸摸屏密碼按鍵

操作提示變色條

隱藏式鎖芯蓋板

指紋採集識別窗口



輕按住蓋板上中位置往下滑
即可打開蓋板



應急機械鑰匙

應急電池接口 (9V)

後面板

電池滑蓋

電池倉

管理按鍵

ZigBee模塊

保險旋鈕

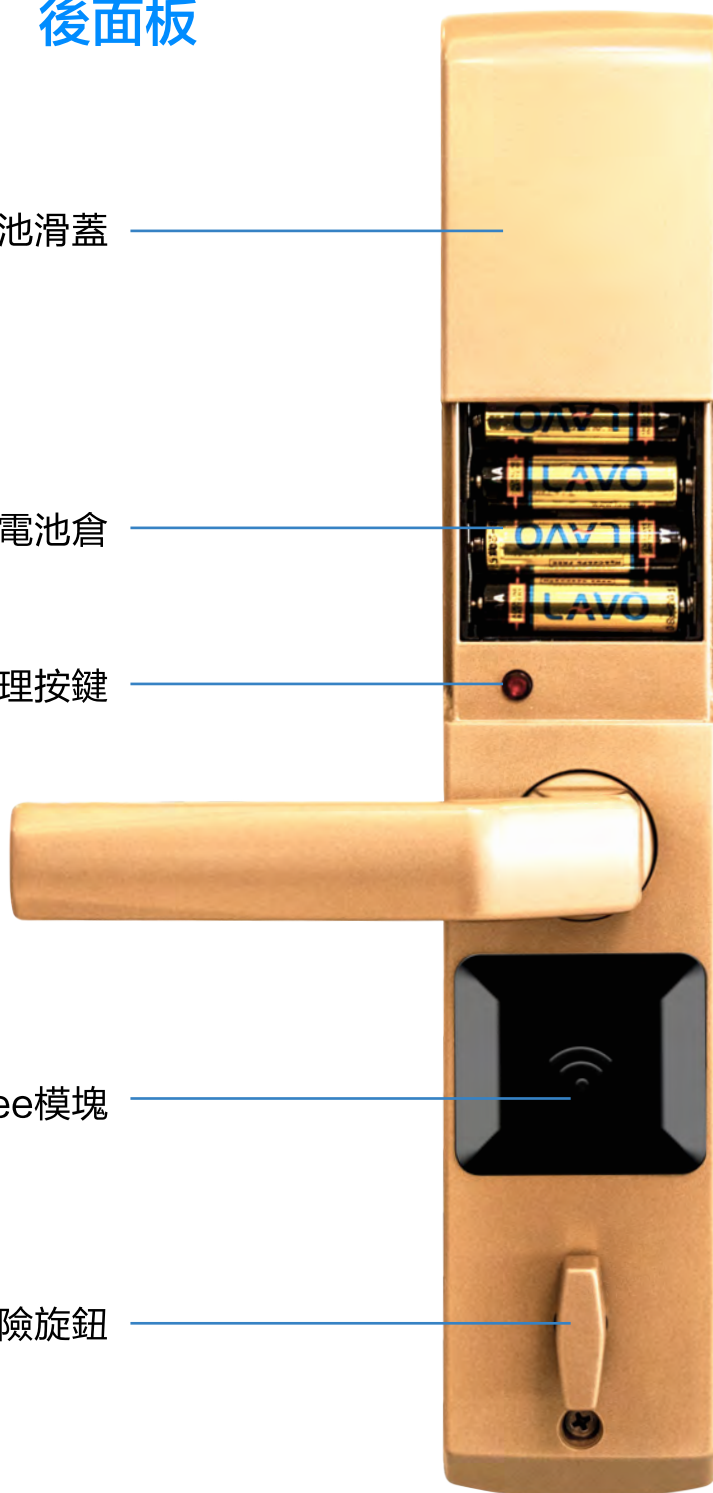

注意： 鎖上方式， 請拉起保險鈕並旋轉
開啟方式， 請直接旋轉保險鈕

5.門鎖按鍵說明

| 序號 | 名稱 | 定義 |
|----|-------|------------------------------|
| 1 | “1” 鍵 | 密碼設定：用戶密碼設置：指紋登入：語音設定：語言模式 |
| 2 | “5” 鍵 | 指紋設定：管理密碼設置：指紋刪除：雙重保安設定：英文模式 |
| 3 | “9” 鍵 | 網絡連接設定；其他設定：靜音模式 |
| 4 | “*” 鍵 | 啟動設定；繼續登入指紋 |
| 5 | “#” 鍵 | 結束 |

6.密碼設置

a. 用戶密碼設置

操作步驟

語音提示

打開後鎖體電池滑蓋
短按一下“紅色管理按鍵”



歡迎使用樂沃智慧門鎖，密碼設置請按1，指紋設置請按3，其它設置請按9

按數字鍵“1”



用戶密碼設置請按1
管理密碼設置請按2

按數字鍵“1”



請輸入管理密碼，按#號鍵結束

輸入管理密碼，按#號鍵



請輸入新的密碼，按#號鍵結束

輸入新用戶密碼，按#號鍵



請再輸入一次，按#號鍵結束

重複輸入一次，按#號鍵



登入成功

b. 管理密碼設置

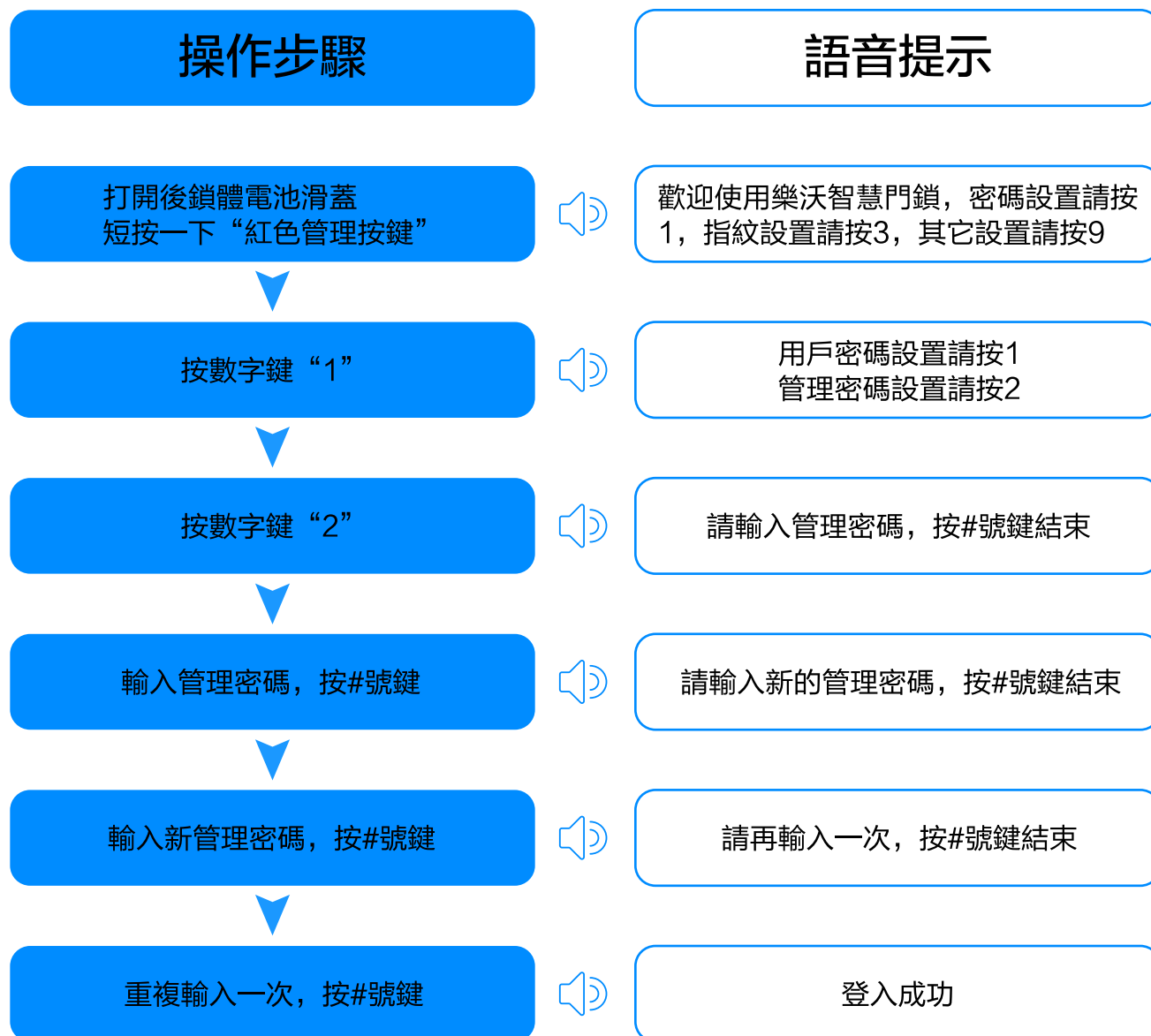

提示：

- 密碼長度為4~16位數字，本鎖出廠初始管理密碼為1234，用戶密碼為空，請及時修改管理密碼。
- 錯誤的密碼：①密碼位數少於4位，多於16位。②輸入正確或不正確密碼後按*號鍵。③密碼不正確。④除上面3種密碼輸入錯誤方式以外的密碼錯誤。第一、第二次輸入密碼錯誤會語音提示“輸入錯誤，請再輸入一次”，第三次輸入密碼錯誤會熄燈斷電，並語音提示“輸入錯誤”。

7.指紋設置

操作步驟

語音提示

打開後鎖體電池滑蓋
短按一下“紅色管理按鍵”



歡迎使用樂沃智慧門鎖，密碼設置請按1，指紋設置請按3，其它設置請按9

按數字鍵“3”



已登入xx枚指紋，指紋登入請按1，指紋刪除請按2

按數字鍵“1”



請輸入管理密碼，按#號鍵結束

輸入管理密碼，按#號鍵



請輸入要登入的編號，按#號鍵結束

輸入編號(0~99)，按#號鍵



請按手指

輸入指紋



請再按一次

輸入指紋(同一手指)



請再按一次

輸入指紋(同一手指)



登入成功，結束請按#號鍵
繼續登入請按*號鍵

8.指紋刪除

操作步驟

語音提示

打開後鎖體電池滑蓋
短按一下“紅色管理按鍵”



歡迎使用樂沃智慧門鎖，密碼設置請按1，指紋設置請按3，其它設置請按9

按數字鍵“3”



已登入xx枚指紋，指紋登入請按1，指紋刪除請按2

按數字鍵“2”



請輸入管理密碼，按#號鍵結束

輸入管理密碼，按#號鍵



指紋個別刪除請按1
指紋全部刪除請按2

按數字鍵1或2



1：請輸入要刪除的指紋編號，再按#號鍵結束。2：刪除成功

輸入編號 (0~99)，按#號鍵



刪除成功，結束請按#號鍵，繼續刪除請按*號鍵

9. 語言設置

操作步驟

語音提示

打開後鎖體電池滑蓋
短按一下“紅色管理按鍵”



歡迎使用樂沃智慧門鎖，密碼設置請按1，指紋設置請按3，其它設置請按9

按數字鍵“9”



常開功能請按1，雙重保安功能請按2，音量調節請按3，網絡設置請按4，语言设置请按5

按數字鍵“5”



請輸入管理密碼，按#號鍵結束

輸入管理密碼，按#號鍵



中文请按1，英文请按2

按數字鍵1或2



设置成功

10. 音量設置

操作步驟

打開後鎖體電池滑蓋
短按一下“紅色管理按鍵”

按數字鍵“9”

按數字鍵“3”

輸入管理密碼，按#號鍵

按數字鍵1或3調節，按#號鍵確認

語音提示

歡迎使用樂沃智慧門鎖，密碼設置請按1，指紋設置請按3，其它設置請按9

常開功能請按1，雙重保安功能請按2，音量調節請按3，網絡設置請按4

請輸入管理密碼，按#號鍵結束

音量調低請按1，音量調高請按3，按#號鍵結束

設置成功

11. 雙重保安設置

操作步驟

打開後鎖體電池滑蓋
短按一下“紅色管理按鍵”

按數字鍵“9”

按數字鍵“2”

輸入管理密碼，按#號鍵

按數字鍵“1”

語音提示

歡迎使用樂沃智慧門鎖，密碼設置請按1，指紋設置請按3，其它設置請按9

常開功能請按1，雙重保安功能請按2，
音量調節請按3，網絡設置請按4

請輸入管理密碼，按#號鍵結束

雙重保安確認請按1
雙重保安取消請按2

雙重保安功能已開啟

雙重保安功能：先輸入正確密碼後系統會提示“請按手指”，當密碼和指紋都正確時鎖才會開啟。

12.常開功能設置

操作步驟

打開後鎖體電池滑蓋
短按一下“紅色管理按鍵”

按數字鍵“9”

按數字鍵“1”

輸入管理密碼，按#號鍵

按數字鍵“1”

語音提示

歡迎使用樂沃智慧門鎖，密碼設置請按1，指紋設置請按3，其它設置請按9

常開功能請按1，雙重保安功能請按2，
音量調節請按3，網絡設置請按4

請輸入管理密碼，按#號鍵結束

常開確認請按1
常開取消請按2

常開功能已開啟

常開功能說明：即保持鎖體開啟狀態，無需任何驗證下壓把手即可開門。

關閉常開功能：正常輸入正確密碼或指紋後系統會提示“門已關閉”，即同時關閉了常開功能。

13. 網絡設置

操作步驟

語音提示

打開後鎖體電池滑蓋
短按一下“紅色管理按鍵”



歡迎使用樂沃智慧門鎖，密碼設置請按1，指紋設置請按3，其它設置請按9

按數字鍵“9”



常開功能請按1，雙重保安功能請按2，音量調節請按3，網絡設置請按4

按數字鍵“4”



請輸入管理密碼，按#號鍵結束

輸入管理密碼，按#號鍵



入網請求請按1，退網請求請按2，允許遠程操作請按3，禁止遠程操作請按4

按數字鍵“1”



入網成功

自動聯網：鎖與網關在通電後會自動連接，登陸APP在“我的設備”中即可查看到本鎖；如果沒有自動連接，請按以上步驟手動連接。

無法連接：①請檢查網關是否通電；②鎖與網關的有效距離不要超過50米。

14.初始化設置

打開後面板電池滑蓋，取出電池，按住紅色管理按鍵並裝入電池，約3秒後系統會提示：“正在恢復出廠設置，請勿關閉電源”。此時可以松開管理按鍵，稍後系統會提示：“已恢復出廠設置”。

初始化將清空用戶密碼和所有指紋並回到出廠狀態，初始管理密碼為1234。

15.使用時注意事項

- ◆ 本鎖為精密產品，請勿自行拆卸或組裝本產品。
- ◆ 請用幹布或幹行巾來擦拭本產品，請勿用水清洗。
- ◆ 遷移本產品安裝至另處時，請與本公司聯繫(需另收安裝費用)。
- ◆ 在外部不能正常開門時請用應急鑰匙開門，並及時與本司聯繫。
- ◆ 當系統提示“電池電量不足”時請及時更換正品城性幹電池。
- ◆ 未能及時更換幹電池導致沒電時，可將前面板的隱藏式鎖芯蓋板打開，內附有應急電源接觸點，請使用9V電池激活本產品。
- ◆ 錄入或驗證指紋時，可能由於手指放在指紋採集器的位置有偏差導致操作不成功或采集的指紋圖像品質下降，請盡量把手指放在採集器的正中。



請勿用水清洗



應急電源（9V）



請勿自行拆卸

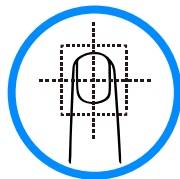

正確採集指紋

16.售後服務

- 產品發生異常時請及時聯繫本公司售後客服中心
- 請妥善保管維修卡，如丟失後發生不良問題則需要有償售後。
- 產品保修期內，本公司將提供無償售後服務；但因使用者自己操作不當導致產品出現異常，將進行有償服務。
- **售後服務中心熱線：400-165-8588**

17.服務基準

| 故障類型 | | 服務內容 | |
|---------------------|--------------------------|-------|-------|
| | | 保修期以內 | 保修期以外 |
| 正常使用狀態 | 安裝後在12個月以內發生故障時 | 無償 | 有償 |
| | 問題發生2次時 | 無償 | 有償 |
| | 問題發生3次時 | 更換產品 | 有償 |
| 使用者的故意或過失 | 乾電池更換錯誤，註冊方法部署了等使用者過失造成的 | 有償 | 有償 |
| | 更換乾電池等消耗品 | 有償 | 有償 |
| | 超出本產品本身使用目的而引起的故障或損壞 | 有償 | 有償 |
| | 故意或者使用直接安裝、拆卸而引起的故障或損壞 | 有償 | 有償 |
| | 沒帶應急鑰匙，密碼也忘記，只能破鎖而入時 | 有償 | 有償 |
| 由於天災、戰爭等不可抗力造成的產品故障 | | 有償 | 有償 |

★ 有償維修時，除配件以外，還需另付出差費

LAVO 乐沃

SMART HOME LEADING BRAND



USER MANUAL

L133-ZB

INTELLIGENT FINGERPRINT
COMBINATION LOCK

HAPPY LIFE IS IN YOUR HANDS

First use

The fingerprint lock is the initial state, The fingerprint lock factory is the initial state, the first use to set the user password, the password will activate the panel. specific settings, please refer to page 7 "password settings".

The default administrator password is 1234.

When used for the first time, the gateway and the lock will be automatically connected, if not connected, please refer to page 15 "Network settings".

Instructions for use

Before using this product, please read this instruction manual carefully

Please be sure to keep the book well, so that it can be checked at any time

Please fully understand the contents of the book, the correct use of

Can be downloaded from the website to use the instructions:
www.lavo.cn

Home – service support – Download Center

Unified service hotline: 400-165-8588



HONG YOUNG METALLIC (KUNSHAN) CO., LTD. Belonging to the LCM group, founded in 1968. The group currently has a total of two Taiwan and main-land factories and stores across the country and distribution points, the number of employees has reached more than 2 thousand people. The products are sold to more than 80 countries and regions around the world, service and sales network all over the world.

The company has from product development, design, mold development and manufacturing, die-casting, machining, polishing, electroplating, paint to process has been operating portfolio packaging, with all kinds of professional production equipment and quality inspection equipment, mainly including: CNC machining center, die casting machine, low pressure casting machine, gravity casting machine, forging machine, automatic punching machine CNC cutting machine, CNC EDM machine, CNC milling machine, high speed CNC and ordinary lathe, grinding machine, drilling machine, automatic processing machine, automatic polishing, China first set of environmental non cyanide electroplating automatic production line, precision materials spectrum analysis instrument, digital phase analyzer and a variety of professional quality testing equipment etc.. Is currently the largest fingerprint lock manufacturers, but also for occident and South Korea and other global famous brands provide OEM/ODM processing products manufacturers.

LIST

- 1 Correct Fingerprint Input
- 2 Features Of Product
- 3 Product Specifications
- 4 Name Of All Parts
- 5 Key Instruction Of Lock
- 6 Password Settings
- 7 Fingerprint Settings
- 8 Deletion Of Fingerprint
- 9 Language Settings
- 10 Volume Settings
- 11 Dual-security Settings
- 12 Normally Open Function Settings
- 13 Network Settings
- 14 Initialization Settings
- 15 Use Precautions
- 16 After-sales Service
- 17 Service Criteria

1. Correct Fingerprint Input

Method for placing a finger

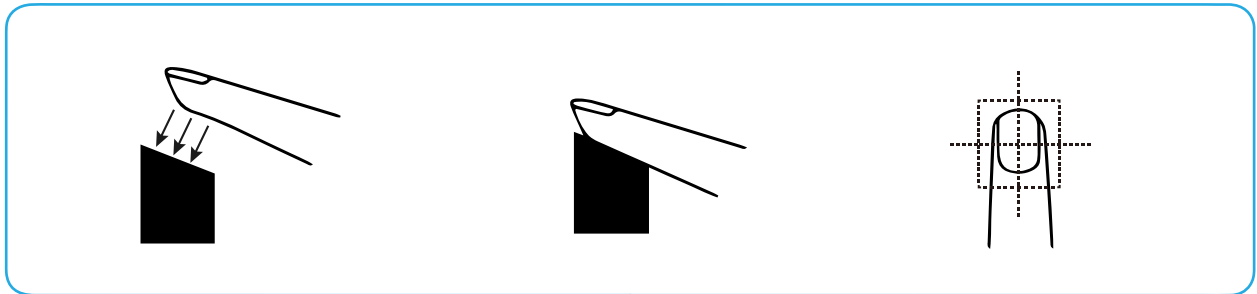

Capacitive 360-degree semiconductor fingerprint recognition

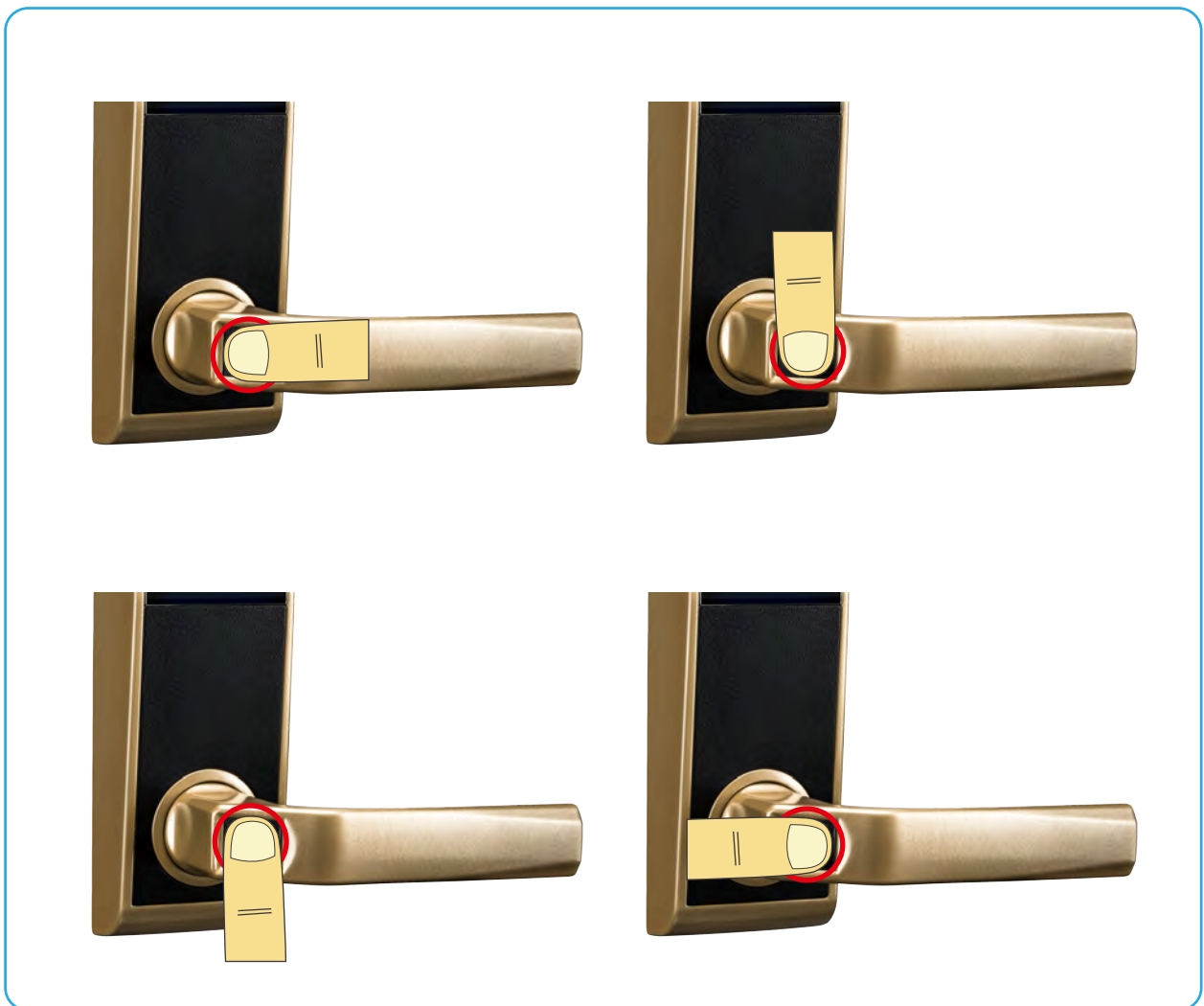

2. Features Of Product

Biological recognition technology for fingerprint

Trustworthy global newest fingerprint arithmetic has an intelligent fingerprint memory function, can record the habitual fingerprint input action, thoroughly solves the problem of artificial false fingerprint, and can guarantee safety.

Capacitive 360-degree semiconductor fingerprint recognition

When the handle is touched, the fingerprint window automatically gets electricity by induction, and the fingerprint recognition speed response is sensitive.

Code keys of touch screen

Toughened glass touch screen and the LED (light-emitting diode) code key are firm and durable, can be operated conveniently, and have sensitive response.

Interference code function by the input of disordered code (prevent the others from peeking code)

Before the correct code is input, any codes with the total bit number not more than 12 can be input, thus preventing the code from leaking. The hand can be used to touch the panel so as to confirm the opening of door, thus prevent the fingerprint from remaining.

Adoption of touch code keyboard

When the digit key is touched, the background light of the digit key turns into red. When the next digit is touched, the background light of the previous digit key turns into white, and the background light of the currently touched digit key turns into red.

Voice prompt function

Real voice prompt function: the Chinese voice and the English voice can be chosen.

Power-on function

The finger can touch the code area so as to carry out power-on, and the power-on operation is not needed to realize by press the power-on key.

Electric shock protection (ESD protection)

The lock can work normally when subjecting to high-voltage electric shock.

World lock function

The electrically controlled lock body is designed according to the domestic theft-protection door. When the user leaves home, the user can lift up the handle and the world lock can be locked, thus increasing the safety.

Indoor locking function

The design of locking button used for preventing wrong touch of child is provided.

Emergent unlocking by emergent mechanical key

When the battery runs out of power or other problems occur, the emergent mechanical key can be used for emergently opening the door.

Dual security

When opening the door, the user must input the correct code and the fingerprint simultaneously before the door is opened, thus reinforcing safety.

Emergent current system (DC9V)

When the battery runs out of power and the door can not be opened, the external power supply can be used.

Low electric quantity prompt function

When the battery has low voltage and the code or fingerprint is input to open the door, it will prompt the user by voice that the electric quantity of the battery is insufficient and please replace the battery in time.

3. Product Specifications

| Name | Specifications | Notes |
|-----------------------------|--|---|
| Outdoor (font lock body) | 70 (W) X 300 (H) X 40 (D) | Voltage: DC6V Temperature: -20°C to +70°C Humidity: 10% to 95%RH |
| Indoor (rear lock body) | 70 (W) X 300 (H) X 35 (D) | |
| Handle | Zinc Die Alloy Casting (front, rear handle) | Complying with human engineering design |
| Others | Three emergency keys | You can enter 4-12 digit password Enter up to 100 fingerprints |
| Weight | 4.5KG | |
| Touch code keys | 12 | Glass touch screen. |
| Power supply | Four 1.5V AA-type halogen dry cells | Battery life 6-12 months (Depending on the battery performance, frequency of use will vary) |
| Lock core | Dual-row atom super-B copper lock core | Material: copper, chrome |

Battery's service life comes from our tests, however it varies with the temperature and humidity of the installed place, frequency of use as well as quality of battery.

Confirm the “+” and “-” poles when installing the batteries. Wrong installation may cause liquid leakage or damage of the batteries. Attention: Do not mix the new batteries with the used or waste batteries. Using poor batteries may cause product abnormalities, please use qualified alkaline batteries.

4. Name Of All Parts

Outdoor lock body

Touch screen
code keys

Operation tips
change colour

Pressure cover plate

Fingerprint collection
window

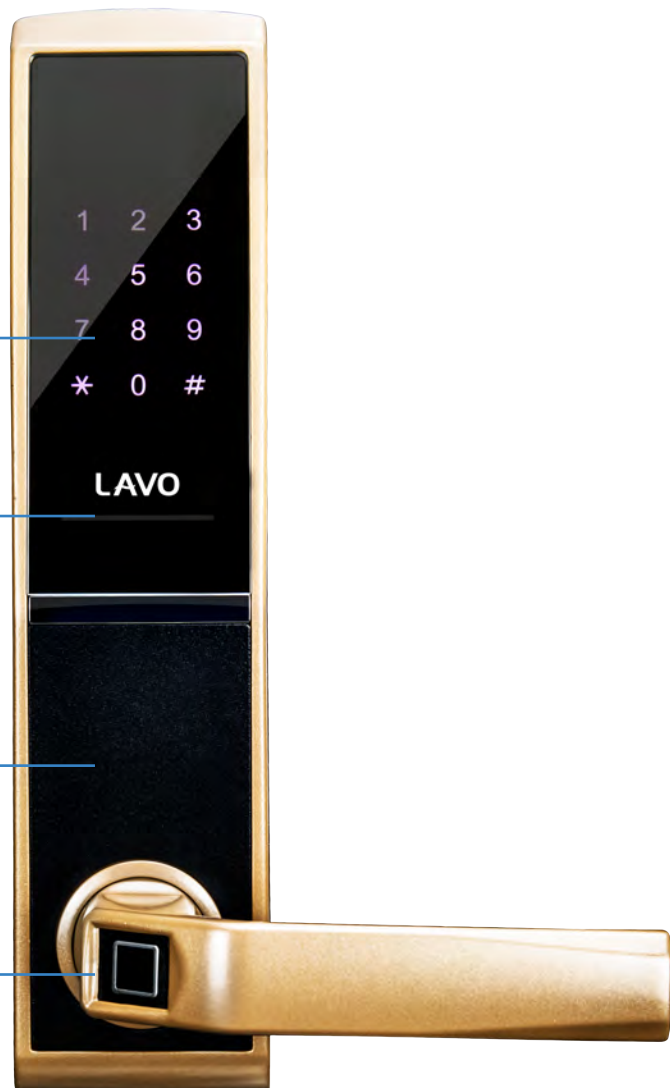

Press and hold the cover to slide down
To open the cover



Emergent mechanical key

Emergent power supply port (9V)

Indoor lock body

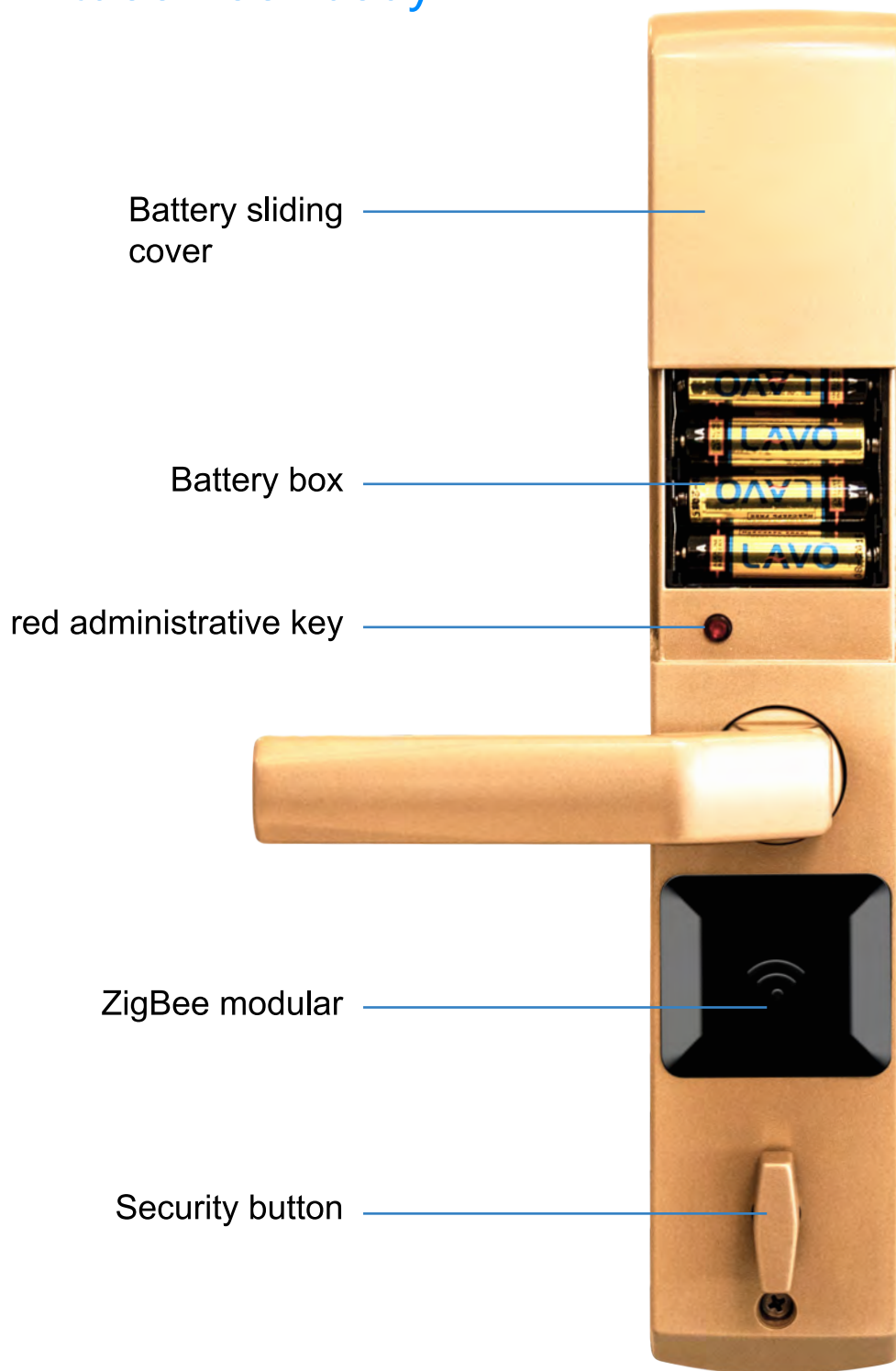

Attention:

For lock up, please pull and turn this switch button.
For unlock, please turn back this switch button.

5. Key Instruction Of Lock

| Serial number | Name | Definition |
|---------------|-------|--|
| 1 | Key 1 | Code setting; setting of user code; fingerprint log-in; voice setting; language mode |
| 2 | Key 5 | Fingerprint setting; setting of administrator code; deleting of fingerprint; dual-security setting; English mode |
| 3 | Key 9 | Connection setting of internet; Other settings; silence mode |
| 4 | Key * | Continue to log in fingerprint |
| 5 | Key # | Over |

6. Password Settings

a. Setting of user code

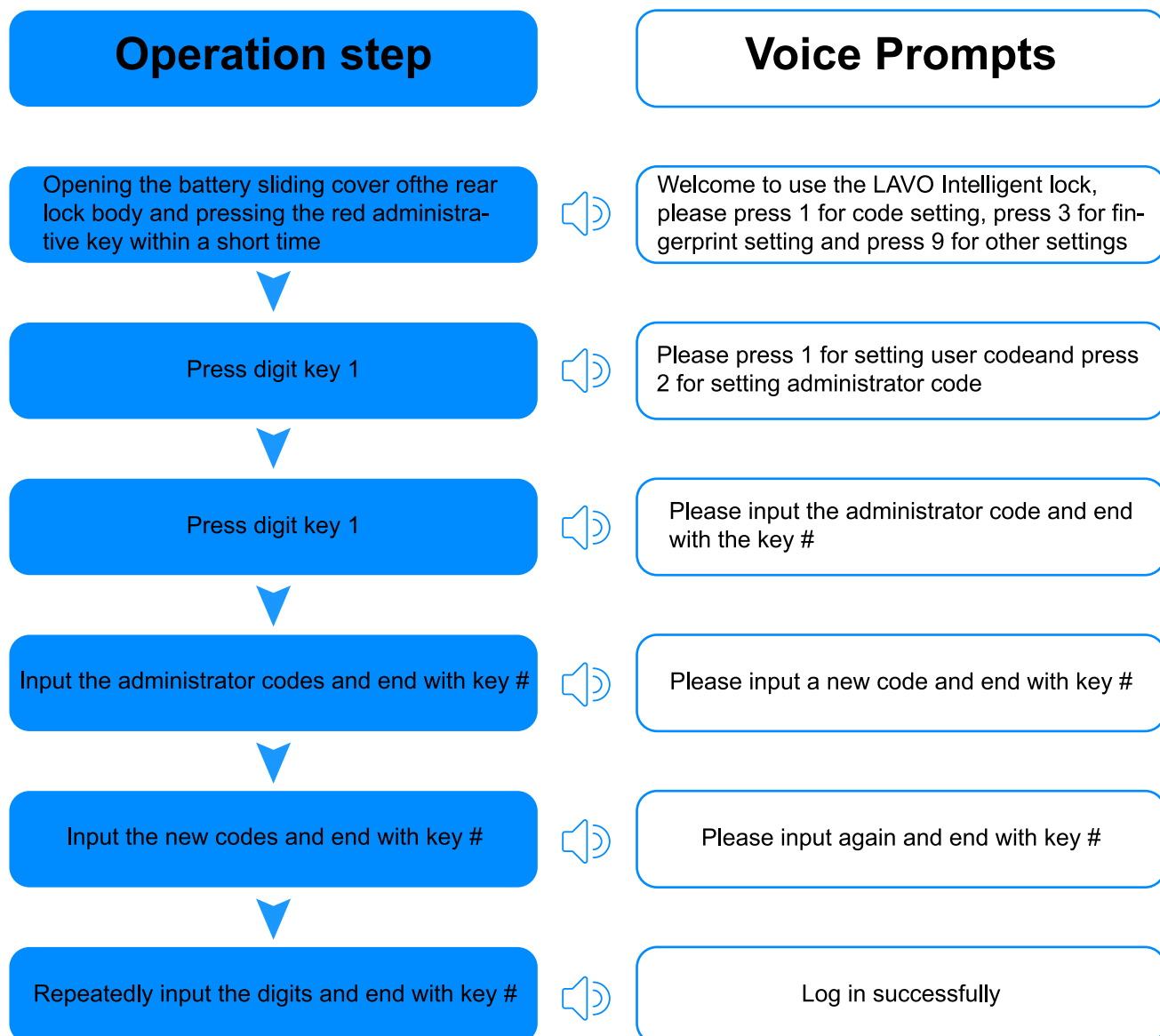

b. Setting of administrator code

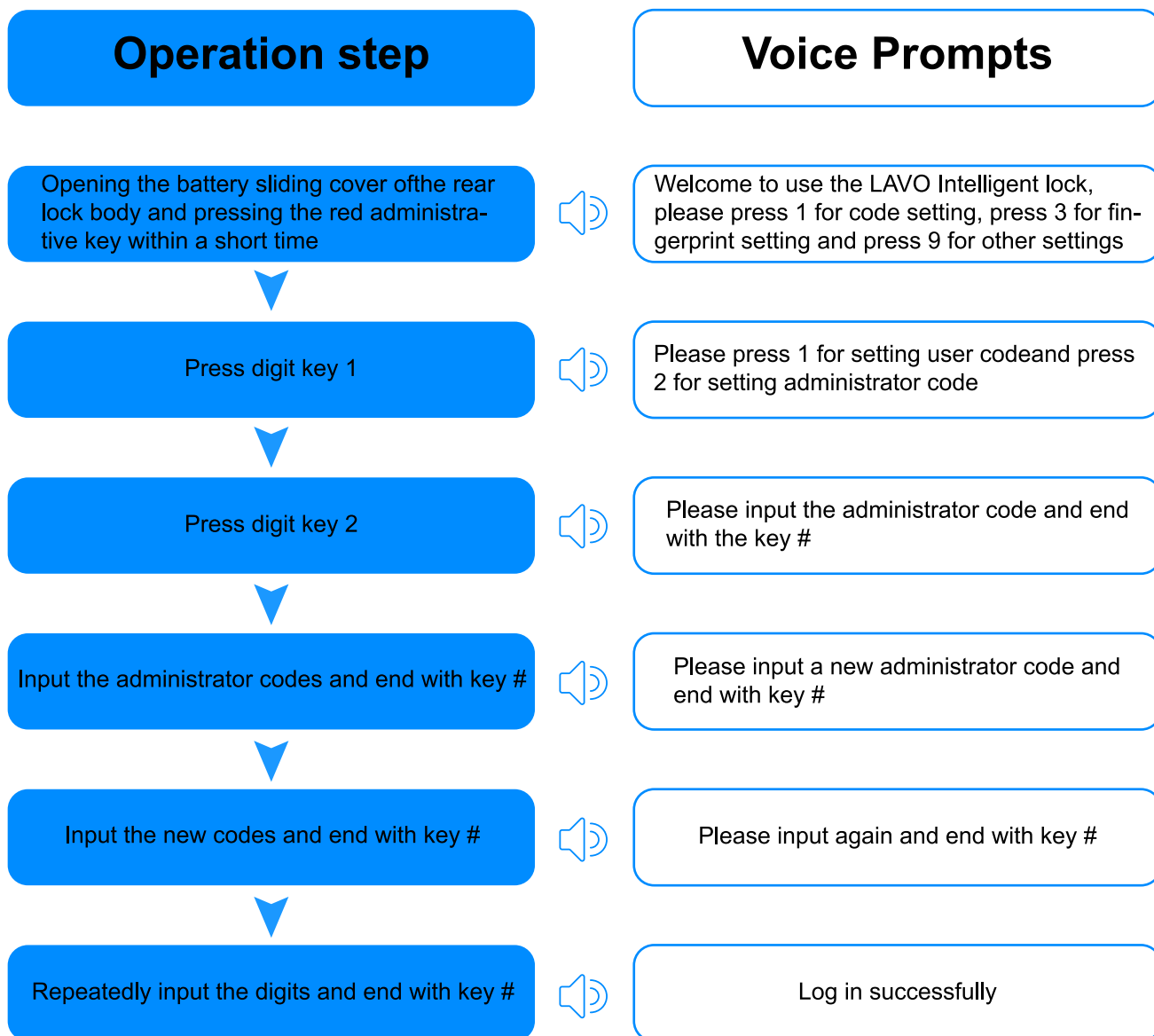

WARN:

1. Password length of 4~16 digits, the lock factory initial management password is 1234, the user password is empty, please modify the password management.
2. Wrong codes: (1) code bit is less than 4 or more than 16; (2) the key * is pressed after the correct or incorrect code is input; (3) the code is incorrect; (4) other code errors besides the abovementioned three code input error types. The voice prompts that the input is wrong and please input again if the wrong code is input for the first time and the second time. If the wrong code is input for the third time, the light is turned off, the power is shut down, and the voice prompts that the input is wrong.

7. Fingerprint Settings

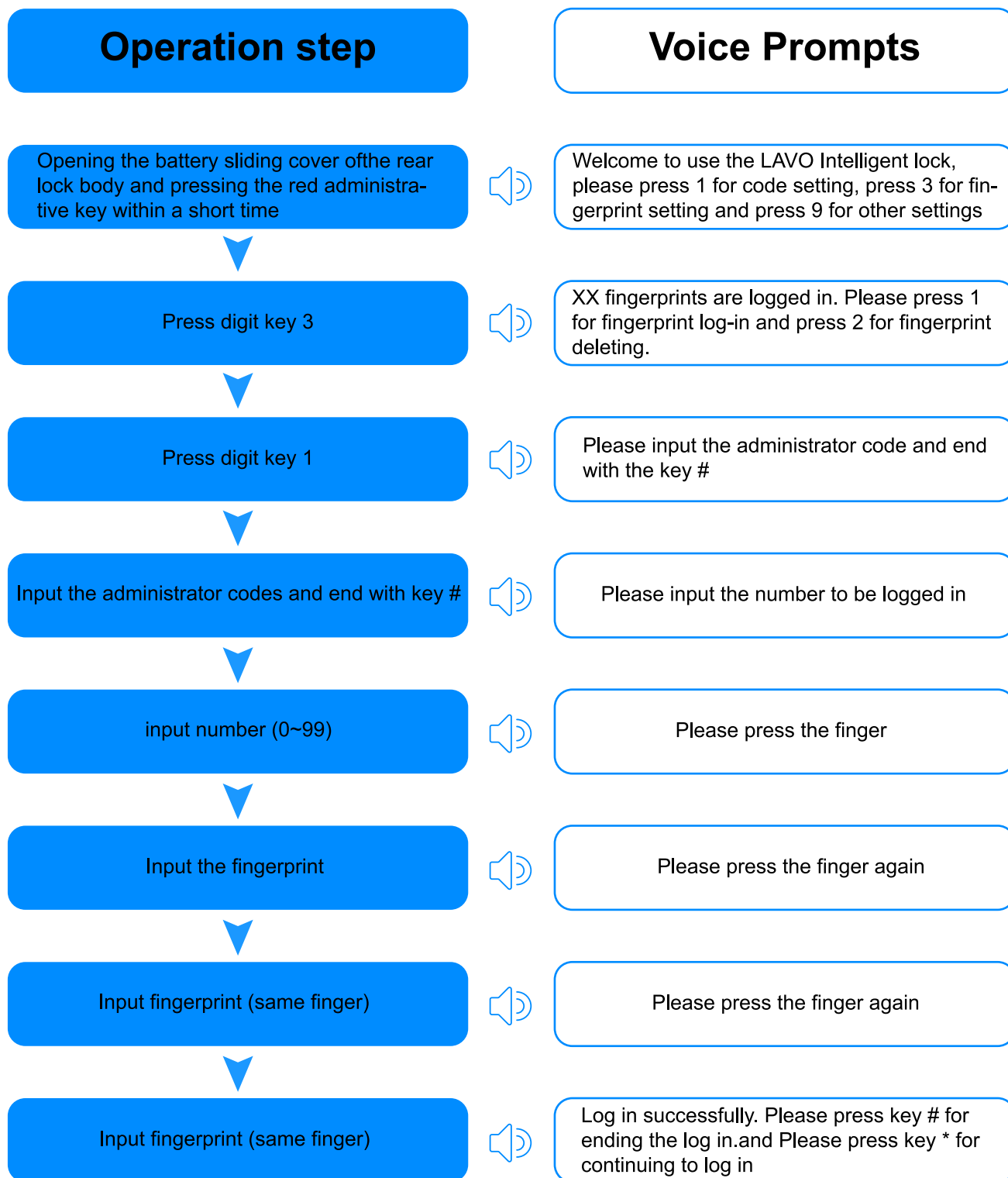

8. Deletion Of Fingerprint

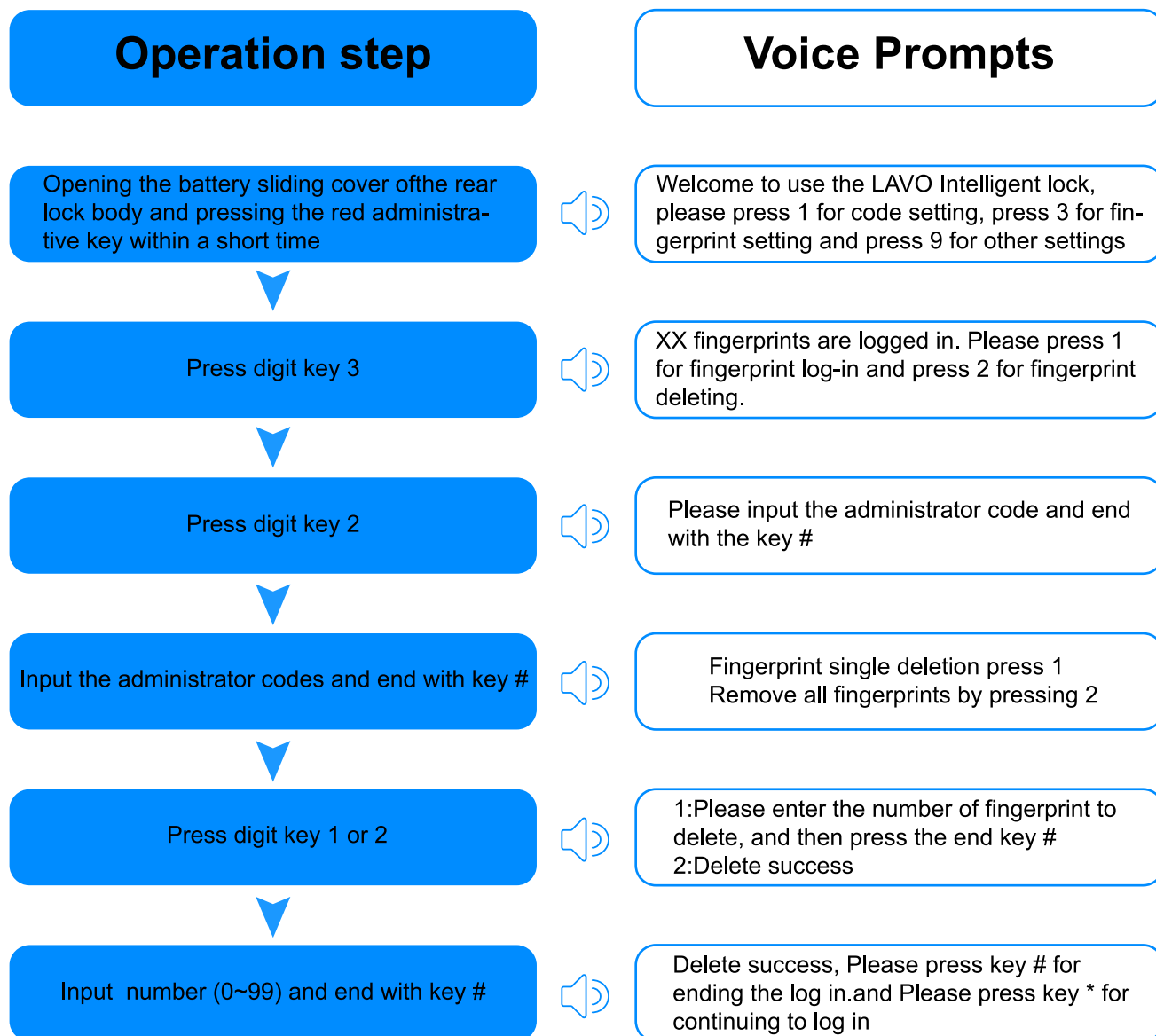

9. Language Settings



10. Volume Settings

Operation step

Opening the battery sliding cover of the rear lock body and pressing the red administrative key within a short time

Press digit key 9

Press digit key 3

Input the administrator codes and end with key #

Press digit key 1 or 2 and end with key #

Voice Prompts

Welcome to use the LAVO Intelligent lock, please press 1 for code setting, press 3 for fingerprint setting and press 9 for other settings

Please press 1 for Normally Open Function Settings, press 2 for Dual-security setting, press 3 for Volume Settings, press 4 for Network Settings, press 5 for Language setting

Please input the administrator code and end with the key #

Volume down press 1, Volume up press 2 end with key #



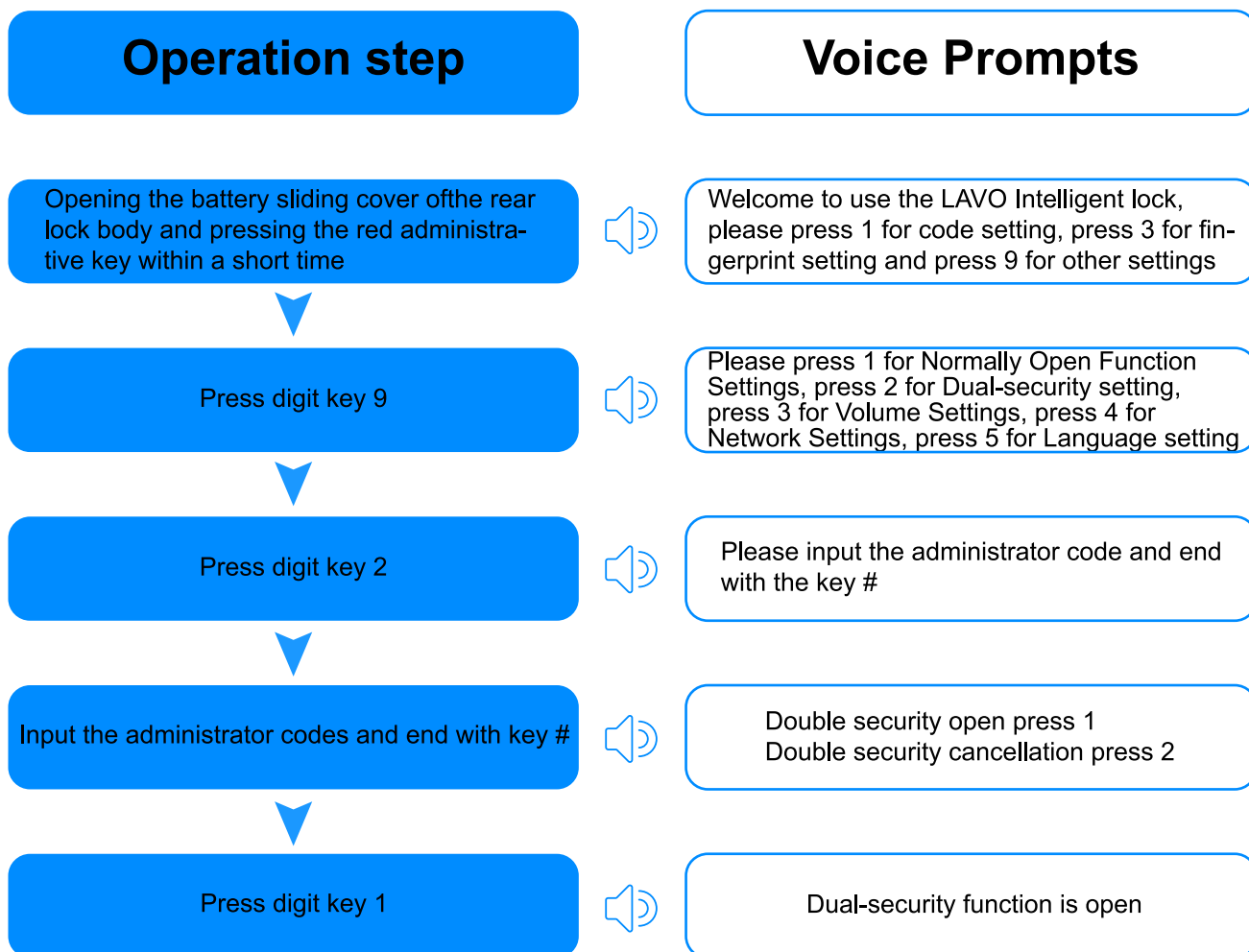

Setting success

11. Dual-security Settings



Dual-security function: Enter the correct password, the system will prompt "press the finger", when the password and fingerprint are correct, the lock will open.

12. Normally Open Function Settings

| Operation step | | Voice Prompts |
|---|---|--|
| Opening the battery sliding cover of the rear lock body and pressing the red administrative key within a short time |  | Welcome to use the LAVO Intelligent lock, please press 1 for code setting, press 3 for fingerprint setting and press 9 for other settings |
| Press digit key 9 |  | Please press 1 for Normally Open Function Settings, press 2 for Dual-security setting, press 3 for Volume Settings, press 4 for Network Settings, press 5 for Language setting |
| Press digit key 1 |  | Please input the administrator code and end with the key # |
| Input the administrator codes and end with key # |  | Normally open please press 1 Normally open cancel press 2 |
| Press digit key 1 |  | Normally open function is open |

Normally open function description: to maintain the open state of the lock, you can open the door without any verification.

close the normally open function: normal input the correct password or fingerprint system will prompt the door is closed, and then close the normally open function.

13. Network Settings

Operation step

Voice Prompts

Opening the battery sliding cover of the rear lock body and pressing the red administrative key within a short time



Welcome to use the LAVO Intelligent lock, please press 1 for code setting, press 3 for fingerprint setting and press 9 for other settings

Press digit key 9



Please press 1 for Normally Open Function Settings, press 2 for Dual-security setting, press 3 for Volume Settings, press 4 for Network Settings, press 5 for Language setting

Press digit key 4



Please input the administrator code and end with the key #

Input the administrator codes and end with key #



Network request press 1, to exit the network request press 2, press 3 to allow remote operation, remote operation is prohibited press 4

Press digit key 1



Access success

Automatic networking: lock and gateway will be automatically connected after power up, landing APP in the "my device" will be able to view the lock; if there is no automatic connection, please follow the steps above to manually connect.

Can not be connected: please check whether the power on the gateway; lock and gateway effective distance not more than 50 meters.

14. Initialization Settings

Open the battery cover on the rear panel, remove the battery, press the red button and load the battery for about 3 seconds Prompt: "restore factory settings, do not turn off the power supply". Later on the system will prompt: "factory settings".

Initialize the user password and all fingerprints will be emptied and returned to the factory state, the initial administrator password is 1234.

15. Use Precautions

- ◆ This lock is a precision products, don't disassemble or assemble the product.
- ◆ Please use dry cloth or dry cloth to wipe the product, do not wash with water.
- ◆ Migration when the product installation to another place, please contact our company (need additional installation fee).
- ◆ Not normal to open the door, please use the emergency key to open the door, and timely contact with my company.
- ◆ When the system prompt battery power is insufficient, please replace the original alkaline dry battery.
- ◆ When there is no to replace the dry battery lead to no electricity, open the hidden cover plate of the front panel, there are emergency power contact points, please use the 9V battery to activate the product.
- ◆ When the fingerprint is input in or compared, the operation may fail or the quality of the collected fingerprint image may decline because the fingerprint is not arranged at the position of the fingerprint collector without deviation. Please place the finger at the center of the finger collector as much as possible when input the fingerprint.



Don't wash with water



Emergency battery (9V)



Don't privately
disassemble

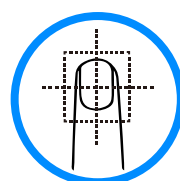

Collecting fingerprint
correctly

16. After-sales Service

▲ Please contact with the client service department if any problems occur to the product.

▲ During the installation process of the product, please take care of the maintenance card. If bad problems occur after the maintenance card is lost, the after-sale service is payable within one year after the product is sold.

▲ During the warranty period, the company provides gratuitous after-sale service. However, if the product is damaged owing to incorrect operation or inattention of the user, or the warranty period is exceeded, the after-sale service is payable.

▲ **A/S: 400-165-8588**

17. Service Criteria

| Type of Failure | | Contents of Service | |
|---------------------------------|--|------------------------|---------------------------|
| | | Within Warranty Period | Exceeding Warranty Period |
| Normal use status | Failures occurred within 12 months after installation | Free | Charged |
| | An issue occurred twice | Free | Charged |
| | An issue occurred 3 times | Replace the product | Charged |
| User's intention, or negligence | Failures due to wrong battery replacing, wrong register or other user's reasons | Charged | Charged |
| | Replacing batteries or other consumables | Charged | Charged |
| | Failures or damages due to using the product for other purposes | Charged | Charged |
| | Failures or damages made on purpose or due to arbitrary installation or detachment | Charged | Charged |
| | Having to damage the lock due to no emergency key on hand or forgetting the cipher | Charged | Charged |
| | Product failures due to natural disasters, war or other force majeure acts | Charged | Charged |

★ In performing charged maintenances, expenses for trip shall be charged in addition to the costs for accessories.



集團總部 立晟金屬企業股份有限公司

HEADQUARTER LIH CHERN METALLIC ENTERPRISE CO., LTD.

臺灣彰化市福東街 66 巷 11 號

Add : NO.11.Lane66, Fu-Tong Sr. Fu-shan Li, Changhua, Taiwan

Tel : +886-4-7322121 Fax : +886-4-7323840

E-mail : kevin@lcm.com.tw service@lcm.com.tw

臺北辦事處

TAIPEI OFFICE

臺北市復興北路 2 號 8F-1

Add : 8F-1, No.2, Fu-Shing North Rd., Taipei, Taiwan

Tel : +886-2-27219375 Fax : +886-2-27410722

昆山工廠 宏洋金屬（昆山）有限公司

KUNSHAN FACTOR HONG YOUNG METALLIC (KUNSHAN) CO.,LTD.

江蘇省昆山市千燈鎮宏洋路 88 號

Add : No.88, Hong-Young Rd., Qiangdeng Town, Kunshan City, Jiangsu

Tel : +86-512-57478688 Fax : +86-512-57478788

E-mail: kevin@lavo.cn agate@lavo.cn service@lavo.cn



服务热线

A/S : 400-165-8588

A/S : (+886)47-322121 #137

<http://www.lavo.cn>

<http://www.lavo.tw>